



## **EX618cl – EX677cl**

## **SU620cl – SU677cl**

## **Clarus Control**

---

**Wascomat provides efficient washers, dryers, flatwork ironers and wetcleaning systems  
in a size and model for every laundry and wetcleaning need!**



** Wascomat Laundry Equipment**

516-371-4400 • [www.wascomat.com](http://www.wascomat.com)

# WASCOMAT CUSTOMER SUPPORT

Whether you need spare parts or technical advice to guide you to the source of a malfunction, our nationwide network of authorized dealers are able and ready to serve your needs, or call the Wascomat Customer Service Hotlines listed below.

## SPARE PARTS

# 516-371-2000

Before ordering parts, refer to the Wascomat spare parts manual (also available on [www.wascomat.com](http://www.wascomat.com)) to determine the part number(s) for the item(s) you need.

For quick service, please have the following information available:

1. Part Number of the item(s) you need.
2. Model of the machine.
3. Serial number of the machine.
4. Electrical data for the machine:
  - 120 or 208-240 Volt?
  - Single or three phase?
  - 50 or 60 Cycle?

To insure parts order accuracy, only fax or email parts orders are accepted:

- Fax: 516-371-4029
- email: [parts@wascomat.com](mailto:parts@wascomat.com)

## TECHNICAL SUPPORT

# 516-371-0700

For service information, first contact your local authorized Wascomat dealer.

Wascomat technical support can assist you or your technician to diagnose and repair your laundry machines over the phone. Please call from the location where the machines are installed (we suggest you use a cellular or cordless phone), and have the following information available:

1. Model of the machine.
2. Serial number of the machine.
3. Electrical data for the machine:
  - 120 or 208-240 Volt?
  - Single or three phase?
  - 50 or 60 Cycle?
4. An accurate description of the malfunction.

To expedite parts order shipment, please use your credit card.  
We accept: American Express, Mastercard, Visa, Discover, Diner's Club.

## WARRANTY CLAIMS

Wascomat's Technical Support staff will honor valid manufacturer's parts warranty claims providing your Wascomat machines are registered for warranty coverage upon installation. If they are not registered, you can validate your warranty claim by providing information about when and where you purchased the Wascomat machine(s), the model and serial number(s). Additional warranty proof may also be required.

## SAFETY AND WARNINGS SIGNS

Replace If Missing Or Illegible

One or more of these signs must be affixed on each machine as indicated, when not included as part of the front instruction panel.

### LOCATED ON THE OPERATING INSTRUCTION SIGN OF THE MACHINE:

#### CAUTION

1. Do not attempt to open door until "Door unlocked" indicator is lit.
2. Machine must not be used by children.
3. Do not use flammable liquids in this machine.

**MACHINE MUST NOT BE USED BY CHILDREN**

#### FR ATTENTION

1. Ne pas tenter d'ouvrir la porte avant que l'indicateur « Porte déverrouillée » ne soit allumé.
2. La machine ne doit pas être utilisée par des enfants.
3. Ne pas utiliser de liquides inflammables dans cette machine.

**LA MACHINE NE DOIT PAS ÊTRE UTILISÉE PAR DES ENFANTS**

#### ES PRECAUCION

1. No intente abrir la puerta hasta que la luz indicadora este encendida.
2. La maquina no debe ser operado por niños.
3. No use líquidos inflamable en la lavadora.

**LAS MÁQUINAS NO DEBEN SER USADAS POR NIÑOS**

**WARNING:** ALL OPERATING AND MAINTENANCE PROCEDURES SHOWN ON THE NEXT PAGE OF THIS MANUAL MUST BE FOLLOWED DAILY FOR PROPER OPERATION OF YOUR MACHINE.

PLEASE ENTER THE FOLLOWING INFORMATION AS IT APPEARS ON THE MACHINE(S) DATA PLATE(S).

<b>MACHINE TYPE OR MODEL</b>	
<b>MACHINE SERIAL NUMBER(S)</b>	
<b>ELECTRICAL CHARACTERISTICS:</b> _____ VOLTS, _____ PHASE, _____ HZ.	

MAKE CERTAIN TO KEEP THIS MANUAL IN A SECURE PLACE FOR FUTURE REFERENCE.



## IMPORTANT SAFETY INSTRUCTIONS

### IMPORTANTES MESURES DE SECURITE

#### WARNING -

To reduce the risk of fire, electric shock, or injury to persons when using your appliance, including the following:

#### AVERTISSEMENT -

*Pour réduire les risques d'incendie, de choc électrique ou de blessure quand, l'appareil est utilisé, prendre les précautions élémentaires et :*

1. Read all instructions before using the appliance.  
*Lire toutes les instructions avant d'utiliser l'appareil.*
2. This machine must be securely bolted to an uncovered concrete floor.  
*Cette machine doit être solidement fixée sur un sol en béton sans revêtement.*
3. This machine **MUST** be serviced and operated in compliance with manufacturers instructions.  
**CHECK DOOR LOCKS EVERY DAY FOR PROPER OPERATION TO PREVENT INJURY OR DAMAGE.**  
**IF THE DOOR LOCK FAILS TO OPERATE PROPERLY, PLACE THE MACHINE OUT OF ORDER UNTIL THE PROBLEM IS CORRECTED.**  
*IL FAUT QUE cette appareil soit entretenue et actionnée conformément aux instructions du fabricant.*  
**CONTROLEZ LA SERRURE DE PORTE TOUS LES JOURS AFIN DE EVITER DES DOMMAGES OU DES RISQUES PERSONNELLES, SI LA SERRURE DE PORTE NE FONCTIONNE PAS, IL FAUT METTRE LA MACHINE HORS SERVICE JUSQU'À LE PROBLEME SOIT CORRIGÉ.**
4. Do not wash articles that have been previously cleaned in, washed in, soaked in, or spotted with gasoline, drycleaning solvents, or other flammable or explosive substances, as they give off vapors that could ignite or explode.  
*Ne pas laver des articles qui ont été nettoyés ou lavés avec de l'essence, des solvants pour nettoyage à sec ou d'autres substances inflammables ou explosives, ou que l'on a fait tremper dans ces produits. Ces substances dégagent des vapeurs qui peuvent s'enflammer ou exploser.*
5. Do not add gasoline, dry-cleaning solvents, or other flammable or explosive substances to the wash water. These substances give off vapours that could ignite or explode.  
*Ne pas ajouter d'essence, de solvants pour nettoyage à sec ou d'autres substances inflammables ou explosives à l'eau de lavage. Ces substances dégagent des vapeurs qui peuvent s'enflammer ou exploser.*
6. Under certain conditions, hydrogen gas may be produced in a hot-water system that has not been used for 2 weeks or more. **HYDROGEN GAS IS EXPLOSIVE.** If the hot-water system has not been used for such a period, before using a washing machine, turn on all hot-water faucets and let the water flow from each for several minutes. This will release any accumulated hydrogen gas. As the gas is flammable, do not smoke or use an open flame during the time.  
*De l'hydrogène peut être produit dans un système à eau chaude qui n'a pas été utilisé depuis deux semaines ou plus. L'HYDROGÈNE EST EXPLOSIF. Si le système à eau chaude n'a pas été utilisé depuis un certain temps, ouvrir tous les robinets d'eau chaude et laisser l'eau couler pendant plusieurs minutes avant d'utiliser une laveuse, l'hydrogène accumulé, le cas échéant, s'échappera. L'hydrogène étant inflammable, ne pas fumer ou utiliser un appareil à flamme nue pendant que l'eau coule.*
7. Do not allow children to play on or in the appliance. Close supervision of children is necessary when the appliance is used near children.  
*Ne pas permettre aux enfants de jouer sur ou dans l'appareil. Surveiller étroitement les enfants lorsqu'ils se trouvent près de l'appareil qui fonctionne.*
8. Before the appliance is removed from service or discarded, remove the door.  
*Avant de mettre l'appareil hors service ou de jeter, retirer la porte.*
9. Do not reach into the appliance if the tub is moving.  
*Ne pas mettre la main dans l'appareil lorsque la cuve bouge.*

- 
10. Do not install or store this appliance where it will be exposed to the weather.  
*Ne pas installer ou placer cet appareil dans un endroit où il sera exposé aux intempéries.*
  11. Do not tamper with controls.  
*Ne pas trafiquer les commandes.*
  12. Do not repair or replace any part of the appliance or attempt any servicing unless specifically recommended in the user-maintenance instructions or in published user-repair instructions that you understand and have the skills to carry out.  
*Ne pas réparer ou remplacer les pièces de l'appareil ou procéder à l'entretien de celui-ci sauf si les instructions visant l'entretien et les réparations qui doivent être effectués par l'utilisateur le spécifient, si vous comprenez bien ces instructions et si vous possédez les connaissances nécessaires.*
  13. Changing of fuses inside the washing machine may only be carried out by authorized personnel.
  14. This machine **MUST** be connected to a dedicated electrical circuit to which no other lighting unit or general purpose receptacle is connected. Use copper conductor only.  
*Utiliser seulement des conducteurs en cuivre.*

## **NOTICE TO: OWNERS, OPERATORS AND DEALERS**

IMPROPER INSTALLATION AND INADEQUATE MAINTENANCE, POOR HOUSEKEEPING AND WILLFUL NEGLECT OR BYPASSING OF SAFETY DEVICES MAY RESULT IN SERIOUS ACCIDENTS OR INJURY. TO ASSURE THE SAFETY OF CUSTOMERS AND/OR OPERATORS OF YOUR MACHINE, THE FOLLOWING MAINTENANCE CHECKS MUST BE PERFORMED ON A DAILY BASIS.

## **FR NOTICE À L'ATTENTION DES PROPRIÉTAIRES, UTILISATEURS ET REVENDEURS DE MACHINES**

UNE INSTALLATION INCORRECTE ET UN ENTRETIEN INADÉQUAT, DE MÊME QUE LA NÉGLIGENCE OU LA NEUTRALISATION DÉLIBÉRÉES DES DISPOSITIFS DE SÉCURITÉ, PEUVENT ÊTRE CAUSÉS DE BLESSURES OU D'ACCIDENTS SÉRIEUX. POUR ASSURER LA SÉCURITÉ DES CLIENTS ET/OU DES UTILISATEURS DE VOTRE MACHINE, IL EST INDISPENSABLE DE PROCÉDER CHAQUE JOUR AUX CONTRÔLES DE ROUTINE CI-APRÈS.

## **ES AVISO PARA LOS PROPIETARIOS, USUARIOS Y REVENDEDORES DE LAS MÁQUINAS**

UNA MALA INSTALACIÓN Y UN MANTENIMIENTO POCO ADECUADO, ASÍ COMO UNA NEGLIGENCIA O NEUTRALIZACIÓN DELIBERADA DE LOS DISPOSITIVOS DE SEGURIDAD PUEDEN CAUSAR LESIONES U ACCIDENTES GRAVES. PARA GARANTIZAR LA SEGURIDAD DE LOS CLIENTES Y/O USUARIOS DE SU MÁQUINA, RESULTA INDISPENSABLE EFECTUAR A DIARIO LAS SIGUIENTES COMPROBACIONES RUTINARIAS

1. Prior to operation of the machine, check to make certain that all operating instructions and warning signs are affixed to the machine and legible. Missing or illegible ones must be replaced immediately. Be sure you have spare signs and labels available at all times. These can be obtained from your dealer.
2. Check the door safety interlock, as follows:
  - (a) OPEN THE DOOR of the machine and attempt to start in the normal manner:  
For coin-operated models, insert the proper coins to start the machine.  
For manually operated models, place the ON-OFF switch in the ON position and press the Start switch.

### **THE MACHINE(S) MUST NOT START !**

- (b) CLOSE THE DOOR to start machine operation and, while it is operating, attempt to open the door without exerting extreme force on the door handle. The door should remain locked!  
If the machine can start with the door open, or can continue to operate with the door unlocked, the door interlock is no longer operating properly.  
The machine must be placed out of order and the interlock immediately replaced.  
(See the door interlock section of the manual.)
3. DO NOT UNDER ANY CIRCUMSTANCES ATTEMPT TO BYPASS OR REWIRE ANY OF THE MACHINE SAFETY DEVICES AS THIS CAN RESULT IN SERIOUS ACCIDENTS.
4. **Be sure to keep the machine(s) in proper working order:** Follow all maintenance and safety procedures. Further information regarding machine safety, service and parts can be obtained from your dealer.  
All requests for assistance must include the model, serial number and electrical characteristics as they appear on the machine identification plate. Insert this information in the space provided on the previous page of this manual.
5. **WARNING:** DO NOT OPERATE MACHINE(S) WITH SAFETY DEVICES BYPASSED, REWIRED OR INOPERATIVE! DO NOT OPEN MACHINE DOOR UNTIL DRUM HAS STOPPED ROTATING!
- FR **AVERTISSEMENT:** NE PAS FAIRE FONCTIONNER LA (LES) MACHINE(S) AVEC UN DISPOSITIF DE SÉCURITÉ NEUTRALISÉ, RECÂBLÉ OU NON OPÉRATIONNEL! NE PAS OUVRIR LA MACHINE TANT QUE LE TAMBOUR NE S'EST PAS IMMOBILISÉ!
- ES **ADVERTENCIA:** NO USAR NINGUNA MÁQUINA SI SE HA NEUTRALIZADO EL DISPOSITIVO DE SEGURIDAD, SE HAN CAMBIADO LOS CABLES O SI NO FUNCIONA CORRECTAMENTE. NO ABRIR LA MÁQUINA HASTA QUE EL TAMBOR SE HAYA DETENIDO POR COMPLETO.

---

## NOTICE TO INSTALLER

Improper installation of this machine:

- May cause serious damage to the machine.
- May result in other property damage.
- May cause personal injury.
- Will void the manufacturer's warranty.

Improper fastening of this machine to its foundation, inferior foundation materials, an undersized foundation, the use of fabricated steel bases not provided by Wascomat or its approved supplier(s), the use of an improper type, number, or size of mounting bolts, or failure to use proper hardware on mounting bolts may result in damage to the machine that will not be covered by the manufacturer's warranty.

Use of a steel base beneath this machine **DRAMATICALLY INCREASES** the mechanical stress placed on the underlying concrete floor or foundation. This must be taken into consideration when employing a steel base to raise the height of the machine.

Increase the manufacturer's recommended floor or foundation thickness requirements by at least three inches (see installation manual) when using six-inch-high Wascomat steel bases to raise the machine's height.

The use of steel bases more than six inches in height is **NOT** recommended. If installation requires a base higher than six inches, contact Wascomat Technical Support at 516-371-0700 for advice.

Connection to line Voltage or over-current protection devices other than those specified on the data plate may result in severe damage to machine components, and will void the manufacturer's warranty.

Refer to complete installation instructions provided in manuals accompanying the machine.

**Contact Wascomat Technical Support at 516-371-0700 with any questions BEFORE installing this machine. Damage resulting from inadequate installation materials or improper installation techniques will void the manufacturer's warranty.**





# Contents

---

## Contents

Safety Precautions .....	11
Technical data.....	13
Installation .....	21
Transportation and unpacking .....	21
Siting and floor .....	23
Mechanical installation .....	24
Installation SU-model .....	25
Siting.....	25
Floor .....	25
Casting a plinth.....	26
Installing the machine.....	28
Water connections .....	29
Drain connection .....	31
Steam connection .....	32
Connection of external liquid supplies .....	33
Electrical installation.....	35
Function checks.....	41
Manual operation.....	41

The manufacturer reserves the right to make changes to design and component specifications.





## Safety Precautions



**The machine is only intended for water-wash use.**

**Do not allow minors to use the machine.**

**Do not hose down the machine with water.**

**The machine's door lock must under no circumstances be bypassed.**

**If the machine develops a fault, this must be reported to the person in charge as soon as possible. This is important both for your safety and that of others.**

**The machine is not intended to be used by people (including minors) with reduced physical or mental capacity or lack of experience and knowledge. Such people must be instructed in the use of the machine by a person who has responsibility for their safety. Minors must be supervised to ensure that they do not play with the machine.**



**All external equipment which is connected to the machine must be CE/EMC-approved and connected using an approved shielded cable.**



**In order to prevent damage to the electronics (and other parts) that may occur as the result of condensation, the machine should be placed in room temperature for 24 hours before being used for the first time.**



## Technical data

	EX618	EX625	EX630	EX645	EX660	EX677
Innerdrum						
volume litres/ft <sup>3</sup>	75/2.6	105/3.7	130/4.6	180/6.4	240/8.5	300/10.6
diameter mm/inch	520/20 1/2	595/23 7/16	650/25 9/16	725/28 9/16	795/31 5/16	795/31 5/16
Drum speed						
wash rpm	49	49	49	44	42	42
extraction rpm	1100	1025	980	930	890	820
Heating						
electricity kW	5.4/7.5	7.5/10	13	18	23	23
steam	x	x	x	x	x	x
hot water	x	x	x	x	x	x
G-factor	350	350	350	350	350	300
Weight, net kg/lbs	159/350	201/443	267/588	350/771	400/882	509/1122
Sound pressure level dB (A)	65	69	70	75	78	76

## Connections

	EX618	EX625	EX630	EX645	EX660	EX677
Water valves connection	DN20 3/4"	DN20 3/4"	DN20 3/4"	DN20 3/4"	DN20 3/4"	DN20 3/4"
Rec. water pressure psi kPa	30-90 200-600	30-90 200-600	30-90 200-600	30-90 200-600	30-90 200-600	30-90 200-600
Functioning limits for water valve psi kPa	8-145 50-1000	8-145 50-1000	8-145 50-1000	8-145 50-1000	8-145 50-1000	8-145 50-1000
Capacity at 45 psi (300 kPa) gallon/min l/min	5 20	5 20	5 20	8 30	15 60	15 60
Drain valve outer Ø mm/inch	75/3	75/3	75/3	75/3	75/3	75/3
Draining capacity gallon/min l/min	45 170	45 170	45 170	45 170	45 170	45 170
Steam valve connection	DN15 1/2"	DN15 1/2"	DN15 1/2"	DN15 1/2"	DN15 1/2"	DN15 1/2"
Rec. steam pressure psi kPa	45-90 300-600	45-90 300-600	45-90 300-600	45-90 300-600	45-90 300-600	45-90 300-600
Functioning limits for steam valve psi kPa	8-115 50-800	8-115 50-800	8-115 50-800	8-115 50-800	8-115 50-800	8-115 50-800

## Technical data

		<b>SU620</b>	<b>SU630</b>	<b>SU645</b>	<b>SU660</b>	<b>SU677</b>
Innerdrum						
volume	litres/ft <sup>3</sup>	85/3.0	130/4.6	180/6.4	250/8.8	330/11.7
diameter	mm/inch	520/20 1/2	595/23 7/16	650/25 9/16	725/28 9/16	795/31 5/16
Drum speed						
wash	rpm	49	49	44	44	42
extraction	rpm	830	776	742	702	671
Heating						
electricity	kW	5.4/7.5	7.5/10	13	18	23
steam		x	x	x	x	x
hot water		x	x	x	x	x
G-factor		200	200	200	200	200
Weight, net	kg/lbs	135/298	145/320	228/503	287/633	330/727
Sound pressure level						
	dB (A)	63/59	70/64	64/70	68/73	70

## Connections

		<b>SU620</b>	<b>SU630</b>	<b>SU645</b>	<b>SU660</b>	<b>SU677</b>
Water valves connection		DN20 3/4"	DN20 3/4"	DN20 3/4"	DN20 3/4"	DN20 3/4"
Rec. water pressure	psi kPa	30-90 200-600	30-90 200-600	30-90 200-600	30-90 200-600	30-90 200-600
Functioning limits for water valve	psi kPa	8-145 50-1000	8-145 50-1000	8-145 50-1000	8-145 50-1000	8-145 50-1000
Capacity at 45 psi (300 kPa)	gallon/min l/min	5 20	5 20	8 30	15 60	15 60
Drain valve	inch outer Ø mm	3 75	3 75	3 75	3 75	3 75
Draining capacity	gallon/min l/min	45 170	45 170	45 170	45 170	45 170
Steam valve connection		DN15 1/2"	DN15 1/2"	DN15 1/2"	DN15 1/2"	DN15 1/2"
Rec. steam pressure	psi kPa	45-90 300-600	45-90 300-600	45-90 300-600	45-90 300-600	45-90 300-600
Functioning limits for steam valve	psi kPa	8-115 50-800	8-115 50-800	8-115 50-800	8-115 50-800	8-115 50-800

1	Electrical connection
2	Cold water
3	Hot water
4	Hard water (option)
5	Steam connection
6	Drain
7	Liquid detergent supply
8	Control panel
9	Soap box
10	Door opening, EX618: $\varnothing$ 310 mm/12 3/16", EX625: $\varnothing$ 365 mm/14 3/8", EX630: $\varnothing$ 395 mm/15 9/16", EX645, EX660, EX677: $\varnothing$ 435 mm/17 1/8"

	A	B	C	D	E	F	G	H	I	K	L	M	N	O	P	R	S
EX618	720	690	1115	355	720	825	45	1030	220	1010	135	910	830	360	100	240	–
EX625	830	705	1200	365	740	910	45	1115	220	1095	135	995	910	415	100	295	–
EX630	910	785	1325	435	825	1035	125	1245	215	1225	300	1125	–	–	100	305	455
EX645	970	870	1410	470	945	1120	115	1330	230	1290	315	1205	370	410	100	335	485
EX660	1020	915	1445	500	955	1155	100	1360	215	1320	300	1240	350	360	100	360	510
EX677	1020	1060	1445	500	1135	1155	100	1360	215	1320	300	380	–	–	100	360	335

EX618, EX625, EX630

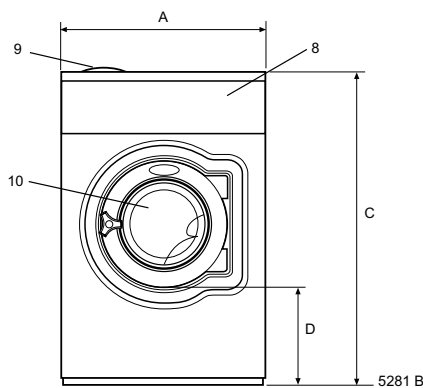

Front

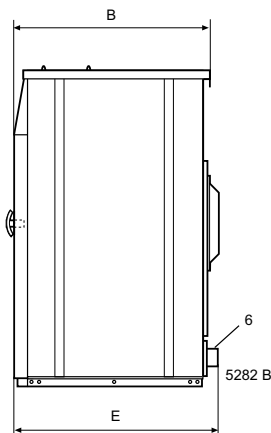

Right side

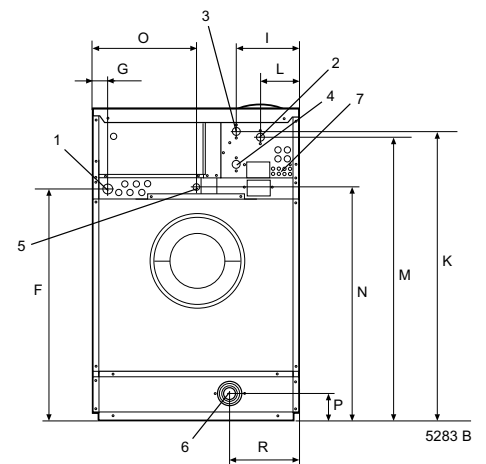

Rear side

EX645, EX660, EX677

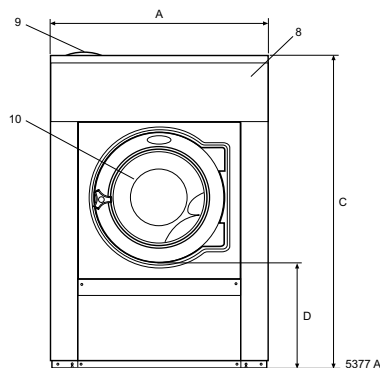

Front

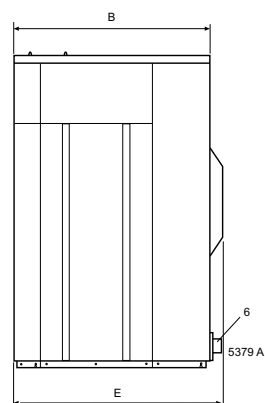

Right side

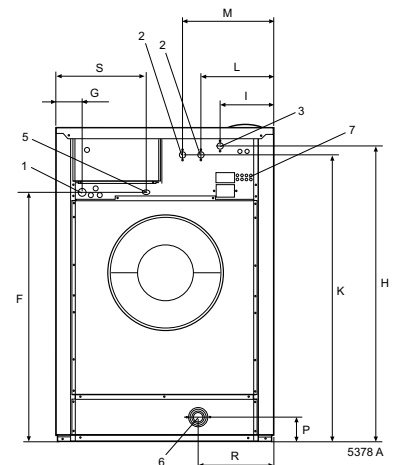

Rear side

in inch	A	B	C	D	E	F	G	H	I	K
<b>EX618</b>	28 3/8	27 3/16	43 7/8	14	28 3/8	32 1/2	1 3/4	40 9/16	8 11/16	39 3/4
<b>EX625</b>	32 11/16	27 3/4	47 1/4	14 3/8	29 1/8	35 13/16	1 3/4	43 7/8	8 11/16	43 5/16
<b>EX630</b>	35 13/16	30 7/8	52 3/16	17 1/8	32 1/2	40 3/4	4 15/16	49	8 7/16	48 1/4
<b>EX645</b>	38 3/16	34 1/4	55 1/2	18 1/2	37 3/16	44 1/8	4 1/2	52 3/8	9 1/16	50 13/16
<b>EX660</b>	40 3/16	36	56 7/8	19 11/16	37 5/8	45 1/2	3 15/16	53 9/16	8 7/16	51 15/16
<b>EX677</b>	40 3/16	41 3/4	56 7/8	19 11/16	44 11/16	45 1/2	3 5/16	53 9/16	8 7/16	51 15/16

in inch	L	M	N	O	P	R	S
<b>EX618</b>	5 5/16	35 13/16	32 11/16	14 3/16	3 5/16	9 7/16	–
<b>EX625</b>	5 5/16	39 3/16	35 13/16	16 5/16	3 5/16	11 5/8	–
<b>EX630</b>	11 13/16	44 5/16	–	–	3 5/16	12	17 15/16
<b>EX645</b>	12 3/8	47 7/16	14 9/16	16 1/8	3 5/16	13 3/16	19 1/8
<b>EX660</b>	11 13/16	48 13/16	13 3/4	14 15/16	3 5/16	14 3/16	20 1/16
<b>EX677</b>	12 3/16	14 15/16	–	–	3 15/16	14 3/16	13 3/16

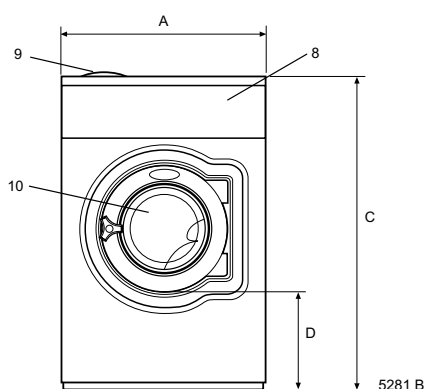
**EX618, EX625, EX630**

Front

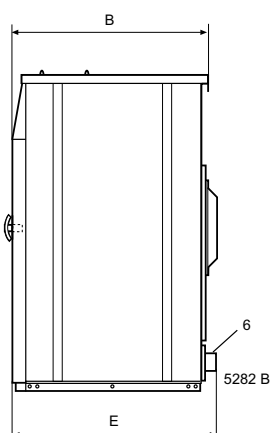

Right side

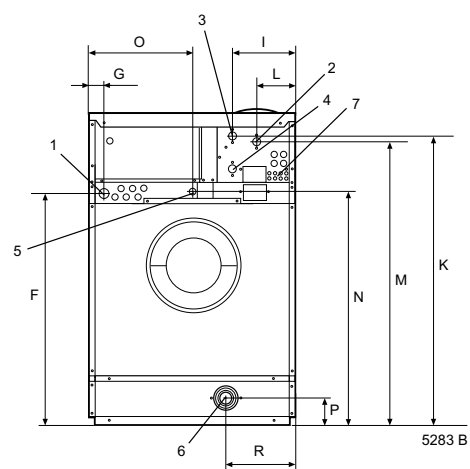

Rear side

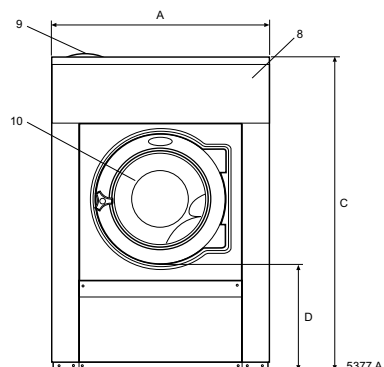
**EX645, EX660, EX677**

Front

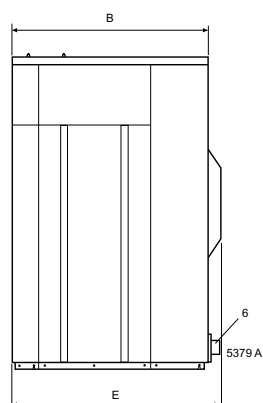

Right side

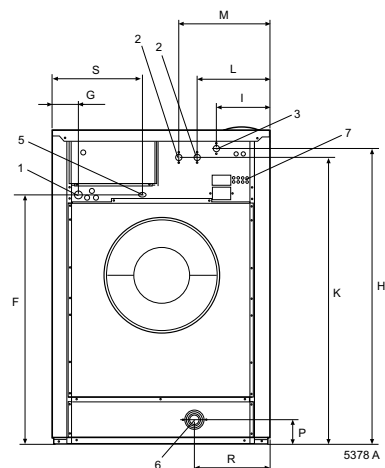

Rear side



1	Electrical connection
2	Cold water
3	Hot water
4	Steam connection
5	Drain
6	Liquid detergent supply
7	Control panel
8	Soap box
9	Water reuse
10	Door opening, SU620: $\varnothing$ 310 mm/12 3/16", SU630: $\varnothing$ 365 mm/14 3/8", SU645: $\varnothing$ 395 mm/15 9/16", SU660, SU677: $\varnothing$ 435 mm/17 1/8"

in mm	A	B	C	D	E	F	G	H	I	K	L	M	N	O	P	R
<b>SU620</b>	660	730	1115	355	765	825	45	1030	215	1010	130	830	385	–	100	225
<b>SU630</b>	720	790	1200	365	825	910	45	1115	215	1095	130	910	420	–	100	235
<b>SU645</b>	750	880	1333	435	915	1035	45	1245	130	1225	210	1040	325	295	100	225
<b>SU660</b>	830	955	1410	470	990	1120	45	1330	160	1290	245	1125	325	325	100	265
<b>SU677</b>	910	1040	1445	500	1075	1155	45	1365	160	1325	245	1155	280	325	100	210

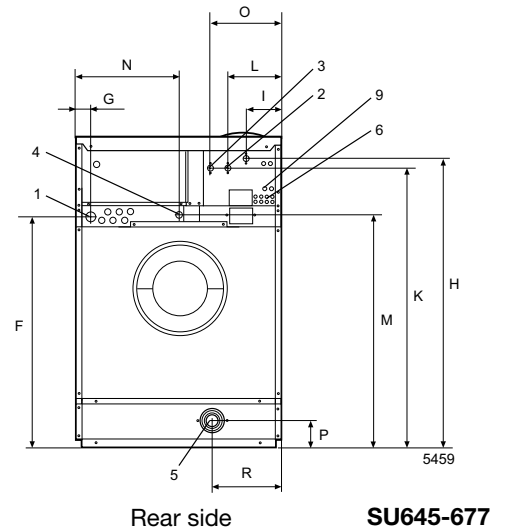
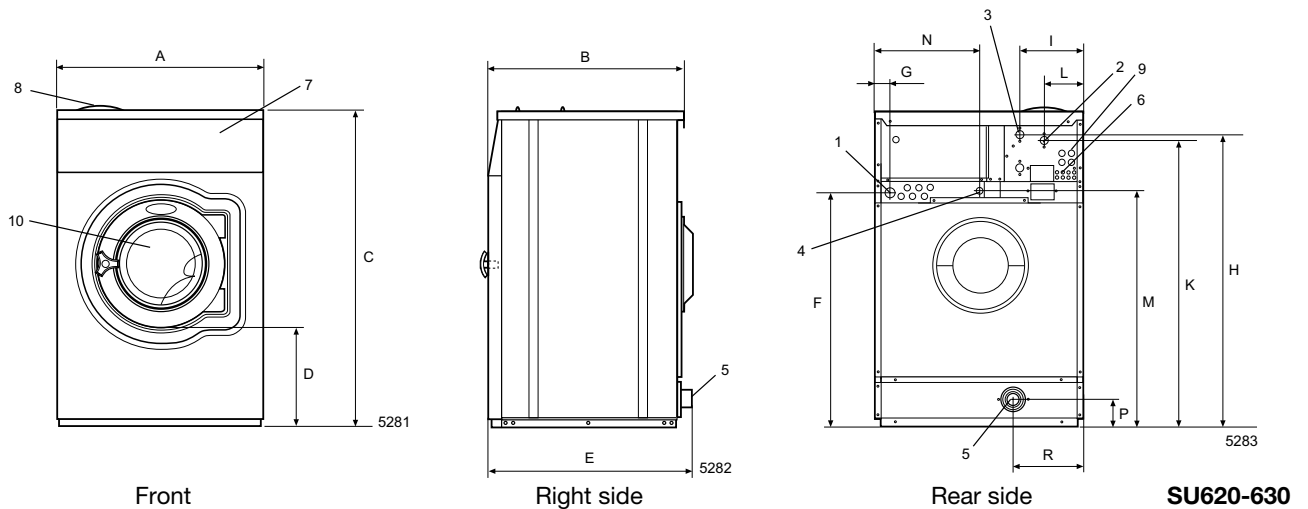

in inch	A	B	C	D	E	F	G	H	I	K
SU620	26	28 3/4	43 7/8	14	30 1/8	32 1/2	1 3/4	40 9/16	8 7/16	39 3/4
SU630	28 3/8	31 1/8	47 1/4	14 3/8	32 1/2	35 13/16	1 3/4	40 7/8	8 7/16	43 1/8
SU645	29 1/2	32 11/16	52 1/2	14 3/8	36	40 3/4	1 3/4	49	5 1/8	48 1/4
SU660	32 11/16	37 5/8	55 1/2	17 1/8	39	44 1/8	1 3/4	52 3/8	6 5/16	50 13/16
SU677	35 13/16	40 15/16	56 7/8	19 11/16	42 5/16	45 1/2	1 3/4	53 3/4	6 5/16	52 3/16

in inch	L	M	N	O	P	R
SU620	5 1/8	32 11/16	15 3/16	–	3 15/16	8 7/8
SU630	5 1/8	35 13/16	16 9/16	–	3 15/16	9 1/4
SU645	8 1/4	40 15/16	12 13/16	11 5/8	3 15/16	8 7/8
SU660	9 5/8	44 5/16	12 13/16	12 13/16	3 15/16	10 7/16
SU677	9 5/8	45 1/2	11	12 13/16	3 15/16	8 1/4

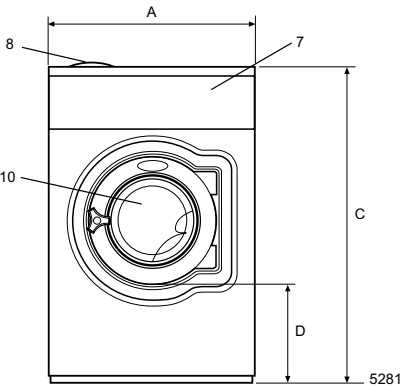

Front

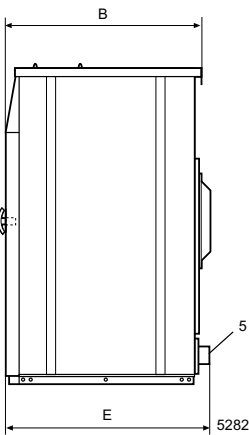

Right side

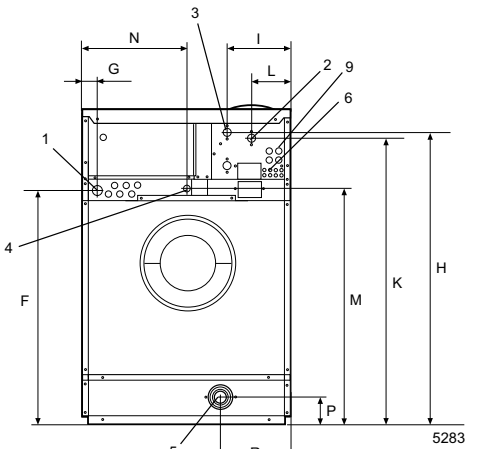

Rear side

SU620-630

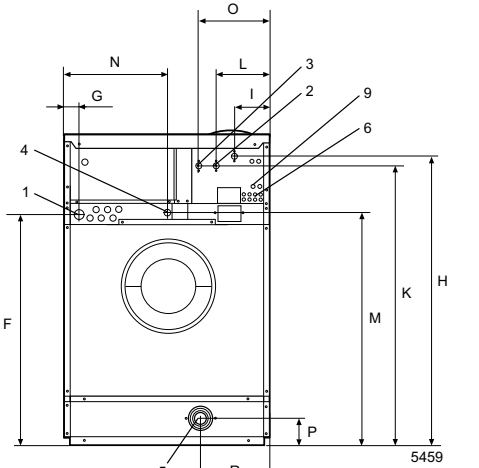

Rear side

SU645-677

	EX618	EX625	EX630	EX645	EX660	EX677
Frequency of the dynamic force      Hz	18.3	17.1	16.3	15.5	14.8	13.7
Max floor load   lbs force at extraction      kN	417±110 1.9±0.5	560±112 2.5±0.5	703±114 3.1±0.5	944±221 4.2±1.0	1158±221 5.2±1.0	1387±277 6.2±1.2

	SU620	SU630	SU645	SU660	SU677
Frequency of the dynamic force      Hz	11.6	10.8	10.3	9.8	9.4
Max floor load   lbs force at extraction      kN	375±741 1.7±3.3	518±1050 2.3±4.7	611±1320 2.7±5.9	842±1663 3.7±7.4	948±1974 4.2±8.8



## Installation

### Transportation and unpacking, EX618, EX625

The machine is delivered complete with expander bolts etc. packed inside the machine in the drum.

The machine is delivered bolted onto the transport pallet and packed in a crate or box.

- Remove packing from the machine.
- Remove front and rear panel. Remove the bolts between the machine and pallet.
- Mount front and rear panel.
- Mount the feet.
- Place the machine on its final position.
- Level the machine with the feet of the machine.

- 1 The machine also comes with transport safety devices (four plate angles between the frame and the drum).

In order to remove the safety devices:

- 2
  - Unpack the machine.
  - Remove front and rear panel.
  - Remove both front metal angels.
  - Remove both rear metal angels.

#### Note!

Once the shipping safety devices have been removed, handle the machine carefully to avoid damage to the suspension components.

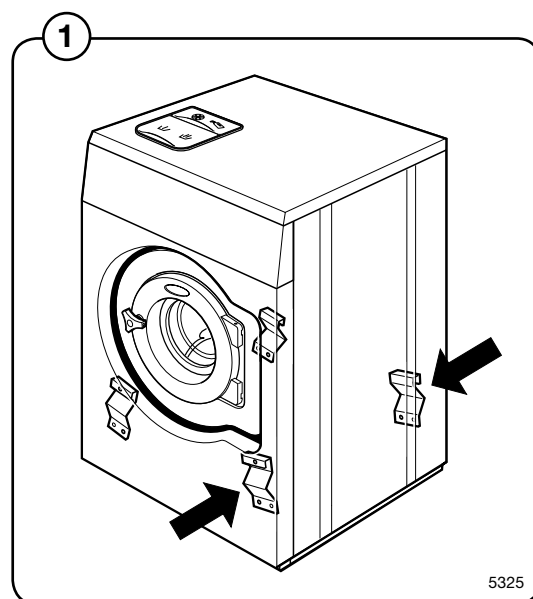

5325

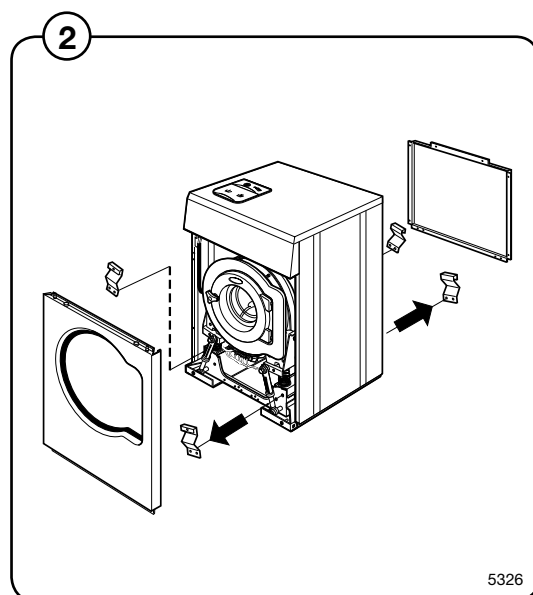

5326

### Transportation and unpacking, EX630, EX645, EX660, EX677

The machine is delivered complete with expander bolts etc. packed inside the machine in the drum.

The machine is delivered bolted onto the transport pallet and packed in a crate or box.

- Remove packing from the machine.
- Remove front and rear panel. Remove the bolts between the machine and pallet.
- Mount front and rear panel.
- Mount the feet.

④

#### **NOTE!**

Regarding EX677 note the positioning of the two front feet.

- Place the machine on its final position.
- Level the machine with the feet of the machine.

③

The machine also comes with transport safety devices (two plate angles between the support and the drum).

In order to remove the safety devices:

- Unpack the machine.
- Remove the two side panels.
- Remove the two transport securities.

⑤

#### **Note!**

Once the shipping safety devices have been removed, handle the machine carefully to avoid damage to the suspension components.

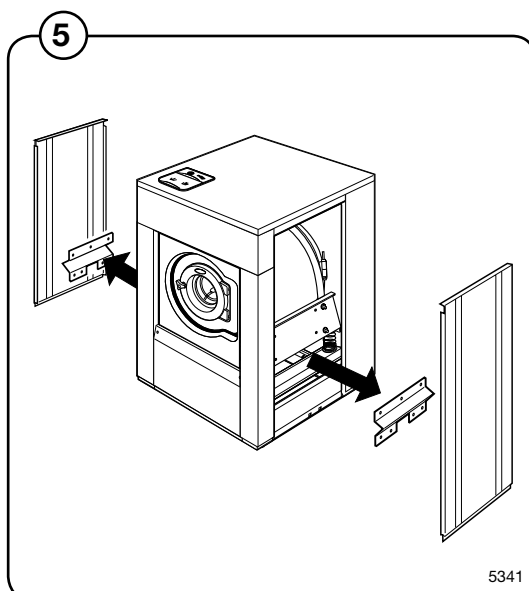
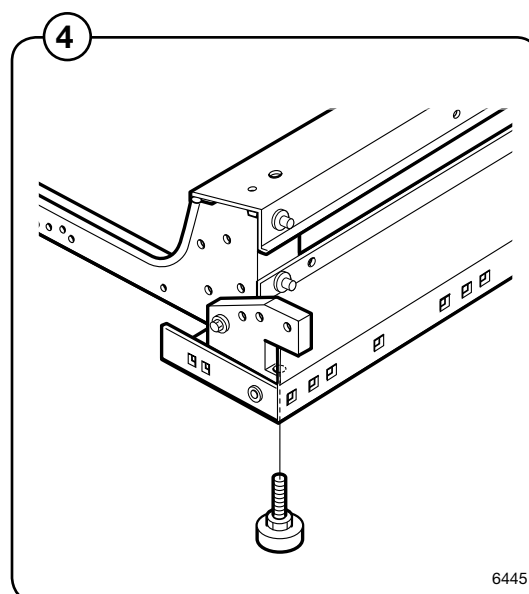
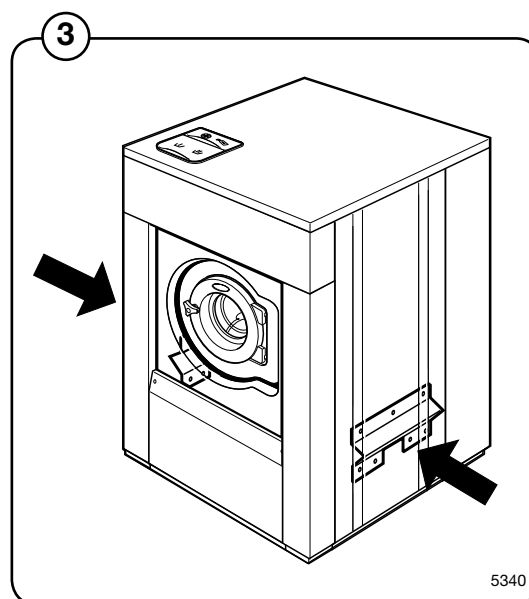

## Siting and floor

Install the machine close to a floor drain or open drain.

- 6 In order to make installation and servicing the machine easier the following clearances are recommended:
- At least 20 inches (500 mm) between the machine and the wall behind
  - and min. 2 inches (50 mm) on both sides of the machine whether installed next to the wall or other machines.

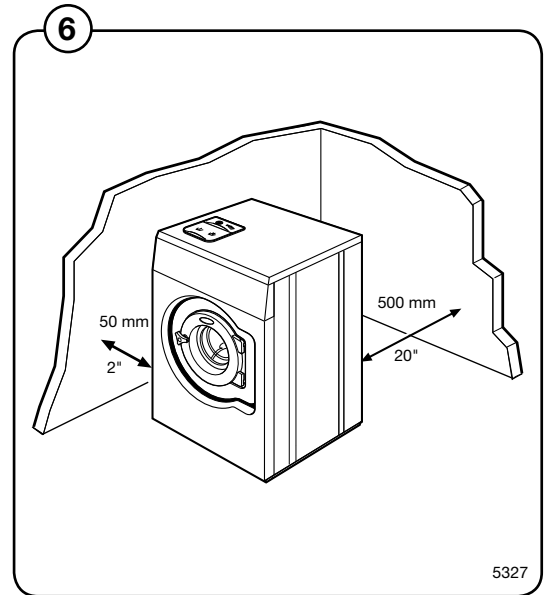

### Mechanical installation

- ⑦ • Mark and drill 2 holes ( $\varnothing$  8 mm/5/16") about 40 mm/1 9/16" deep (EX618-625) and  $\varnothing$  10 mm/3/8" and 50 mm/2" deep (EX630-660) in the positions.

● = position of feet

○ = drilling points for expander bolts

- The machine must be lifted in its base frame.
- Place the machine over the two drilled holes on the foundation.
- Check that the machine is in level, both side-to-side and front to back. Adjust with the feet.



**It is of utmost importance that the machine level, from side to side as well as front to rear. If the machine is not properly leveled, it may result in out-of-balance without a real out of balance in the drum.**

- Mount the expander bolts in the holes drilled in the floor. Fit the washers and nuts, and tighten well.

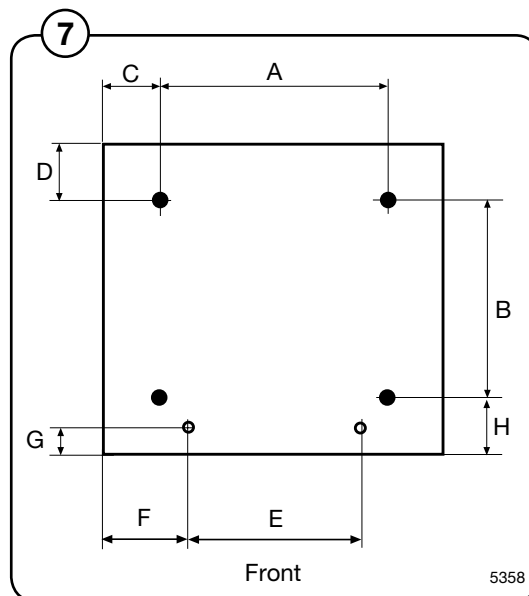

in mm	A	B	C	D	E	F	G	H
EX618	495	460	110	130	375	170	40	100
EX625	575	465	130	140	455	185	35	95
EX630	635	490	135	175	515	195	60	110
EX645	715	545	125	205	595	185	60	115
EX660	790	615	115	180	670	175	60	115
EX677	900	840	60	180	670	175	60	120

in inch	A	B	C	D	E	F	G	H
EX618	19 1/2	18 1/8	4 5/16	5 1/8	14 3/4	6 11/16	1 9/16	3 15/16
EX625	22 5/8	18 5/16	5 1/8	5 1/2	17 15/16	7 5/16	1 3/8	3 3/4
EX630	25	19 5/16	5 5/16	6 7/8	20 1/4	7 11/16	2 3/8	4 5/16
EX645	28 1/8	21 7/16	4 15/16	8 1/16	23 7/16	7 5/16	2 3/8	4 1/2
EX660	31 1/8	24 3/16	4 1/2	7 1/16	26 3/8	6 7/8	2 3/8	4 1/2
EX677	35 7/16	33 1/16	2 3/8	7 1/16	26 3/8	6 7/8	2 3/8	4 3/4



## Installation SU-model

Leave the machine on the transport pallet until it can be placed in the final, prepared position.

### Siting

Install the machine close to a floor drain or open drain. In order to make installation and servicing the machine easier the following clearances are recommended:

- 8 • At least 20 inches (500 mm) between the machine and the wall behind.
- Minimum 1 inch (25 mm) to next machine if more than one machine is installed on a foundation.

### Floor

In this type of machine, the drum is attached directly to the frame. As a result the floor under the machine must be stable enough to absorb the dynamic forces generated during spin cycles. For that reason, the mounting bolts must be cast into the floor material itself.

The machine must be securely fastened to a suitable foundation using M16 (5/8 inch) threaded rod, flat washers and lock nuts or lock washers. Failure to properly secure the machine to its foundation, or securing the machine to an inadequate foundation, will result in severe vibration, damage to the machine, and will void the manufacturer's warranty.

When fixing the machine to an existing cement floor, it must be at least 8 inches (200 mm) thick.

The floor must be able to withstand the loads indicated in the table.

If it isn't possible to cast the bolts into the floor, an alternative might be to use so-called chemical anchors. Your local dealer can provide the information you need.

#### IMPORTANT NOTE:

The use of chemical anchors and/or the use of a fabricated steel mounting base DOES NOT reduce the thickness requirement for the underlying concrete floor. The floor MUST BE AT LEAST 8 INCHES (200 MM) THICK, or a new concrete foundation MUST be poured.

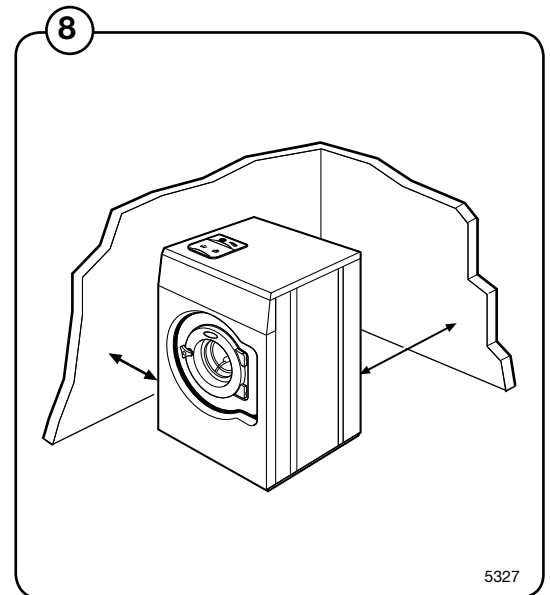

5327

### Casting a plinth

- 9 A foundation should be used where the existing floor is less than 8 inches (200 mm) thick or in order to ensure that the machine is securely anchored and will not vibrate excessively.

The foundation must be at least 8 inches (200 mm) thick.

Proceed as follows:

- 10
- Break up the existing floor to a depth of approx. 5 inches (125 mm) and check that the sides of the hole are tapered outward so that the longest side at the bottom measures 5 inches (125 mm) more than at the top.
  - Make the forms for the foundation.
  - Moisten the hole well and apply cement to the sides and bottom.
  - A number of mounting bolts must be set into the concrete of the foundation. The bolts need to project 1-1 1/2 inches (40 mm) out of the base. Pour the concrete into the prepared base mold and make sure that the surface is level.
  - The concrete should be left to set for at least two days before mounting the machine on the foundation.
  - Mounting bolt locations are shown with respect to the outer surface of the machine's front panel. If the front panel is to be set back from the front of the foundation, add the set-back distance to dimension "E".

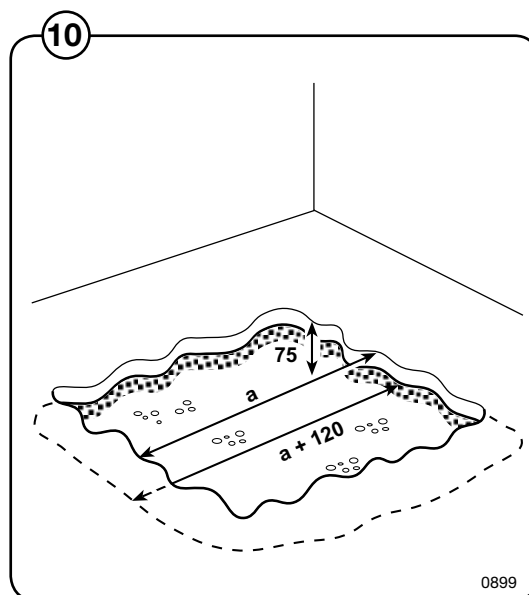
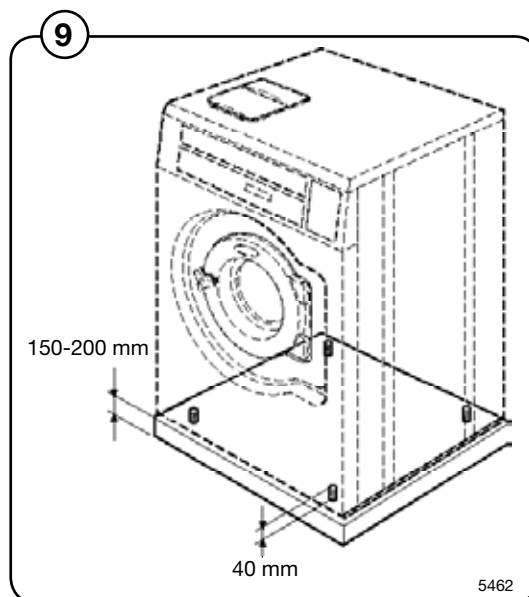

## SU-models

### NOTE!

For above models, two expander bolts must also be fitted to the front section of the machine. If not, large vibrations in the machine cabinet may occur.

11

- Drill two holes (1)  $\varnothing 10$  mm/ 3/8" and 40 mm/ 1 9/16" deep.
- After the machine has been placed over the other four bolts, place the two spacer washers over the two holes. They shall be placed between the machine and foundation.
- Mount the expander bolts in the drilled holes. Fit the washers and nuts, and tighten well.

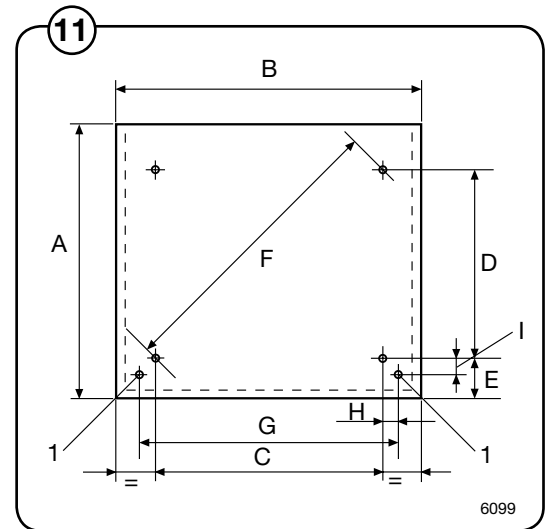

in mm	A	B	C	D	E	F	G	H	I
SU620	725	660	495	445	115	665	495	0	75
SU630	785	720	575	495	120	760	595	10	80
SU645	875	750	635	570	120	855	655	10	85
SU660	950	830	715	635	125	955	735	10	85
SU677	1035	910	790	695	135	1050	810	10	95

in inch	A	B	C	D	E	F	G	H	I
SU620	28 9/16	26	19 1/2	17 1/2	4 1/2	26 3/16	19 1/2	0	2 15/16
SU630	30 7/8	28 3/8	22 5/8	19 1/2	4 3/4	29 15/16	23 7/16	13/32	3 1/8
SU645	34 7/16	29 1/2	25	22 7/16	4 3/4	33 11/16	25 13/16	13/32	3 3/8
SU660	37 3/8	32 11/16	28 1/8	25	4 15/16	37 5/8	28 15/16	13/32	3 3/8
SU677	40 3/4	35 13/16	31 1/8	27 3/8	5 5/16	41 5/16	31 7/8	13/32	3 3/4

## Installing the machine

To install the machine:

- Remove the transport packaging
- Remove the front panel.
- Remove the machine from the transport pallet and locate it on the bolts.  
Always lift the machine by the chassis, never by the door or door handle.
- ⑫ • Check that the machine is level and steady at all four corner mounting points. Adjust the level by using stainless or galvanized steel washers or shims between the machine and the floor. The washers must be of a size to cover the support surface.
- ⑬ • Fit the washers and self-locking nuts supplied with the machine and tighten securely.
- ⑭ • To tighten the nuts we recommend to use a ratchet wrench, especially in the right rear corner.

During the first several weeks of use, check and tighten the nuts (as necessary) frequently. Continue to check them periodically, thereafter.

### IMPORTANT NOTE:

Failure to closely follow the instructions provided in this manual may result in severe damage to the machine, and the risk of personal injury. The manufacturer is not responsible for damage or injury resulting from improper installation.

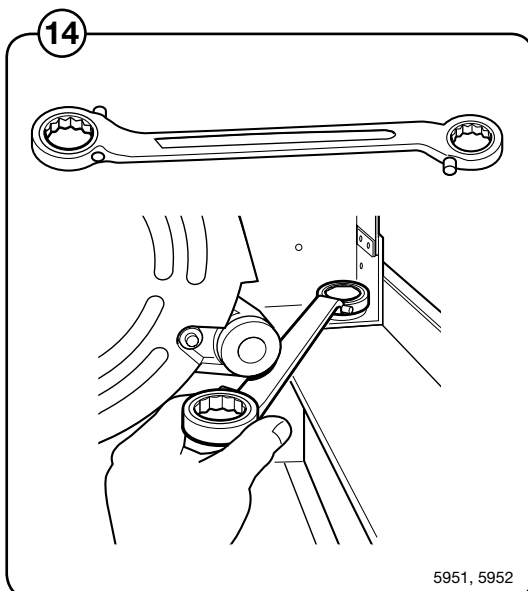
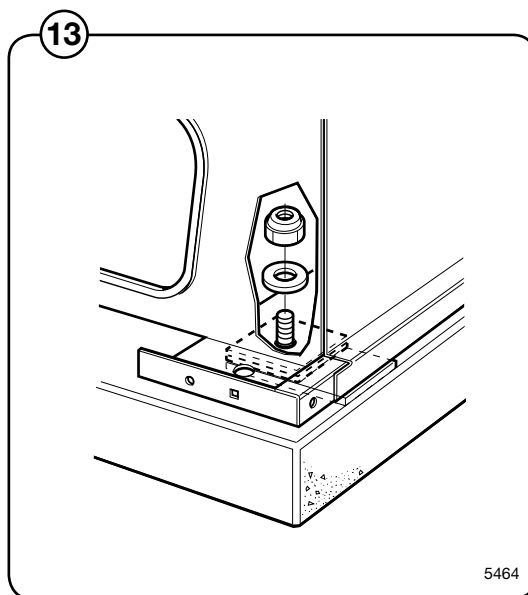
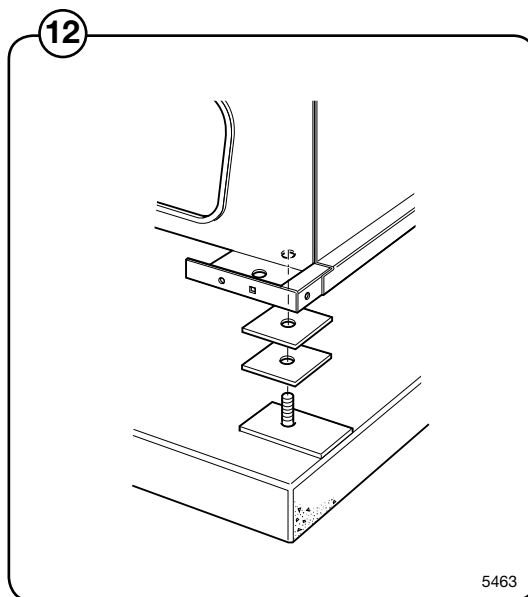

---

## Water connections

All intake connections to the machine are to be fitted with manual shut-off valves and filters, to facilitate installation and servicing.

Water pipes and hoses should be flushed clean before installation. After installation hoses should hang in gentle arcs.

The machine may have between two and four 3/4" DN 20 water connectors. All connectors present on the machine must be connected up. The table shows the possible connection options, which will depend on the water types to be connected to the machine. Check the machine plates too.

All water connectors must be connected up, otherwise the wash program will not function correctly.

Hoses are to be of an approved type and grade, to comply with national regulations.

The water pressure data is as follows:

- min: 6 psi (40 kPa)
- max: 140 psi (1 MPa)
- recommended: 30-90 psi (200-600 kPa)

	Water type	Water connection			
		1	2	3	4
15	cold and hot	cold hot			**
16	cold and hot	cold	hot	cold*/hot	**

\* For detergent container.

\*\* Only machine with Clarus Control.

Extra water valve which can be used for hard water if soft water is connected to 1.

This valve can also be used for water reuse from tank.

If pump is used, it is only a water connection without valve.

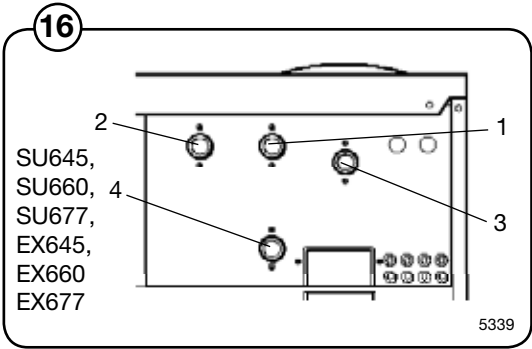
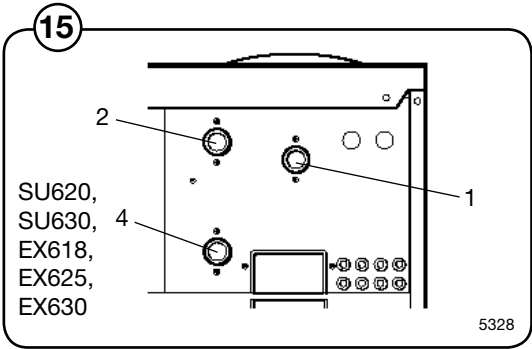

## Drain connection

Connect a 75 mm (2 1/2") pipe or rubber hose to the machine's drain pipe, ensuring a downward flow from the machine. Avoid sharp bends which may prevent proper draining.

- 17 The washer may drain in to a drainage through or into a closed drain system. In either case, be sure to comply with all applicable national and local plumbing code provisions.

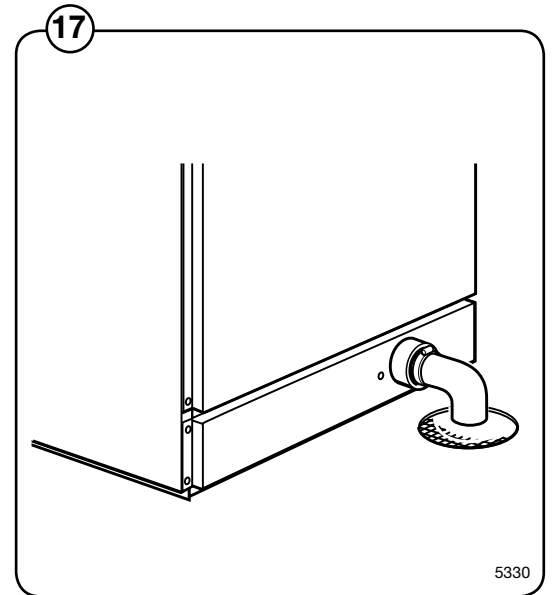

5330

### Steam connection

The water supply to the machine should be fitted with manual shut-off valves and filters to facilitate installation and servicing.

The connection hose must be of type ISO/1307-1983 or equivalent. Connection size at filter: DN 15 (1/2").

Steam pressure required:

- minimum: 7 psi (50 kPa)
- maximum: 115 psi (800 kPa)

- 18 • Remove the cover (A).
- 19 • Mount the articulated nipple to the steam valve.
- 20 • Mount the steam valve on the machine.
- 21 • Mount nipple, strainer and elbow. Note the direction of the strainer. Mount steam hose to the elbow.  
Check that there are no sharp angles or bends on the connected steam hose.
- 22 • Mount the hose with wires between steam valve and machine.  
Connect wires in the steam valve.  
Connect ground cable to the terminal ground connection.  
Mount the cable connector on X46 on distribution card.

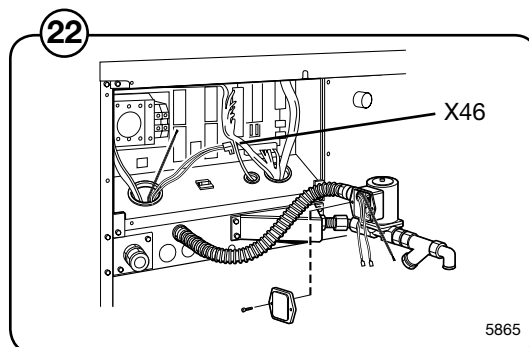
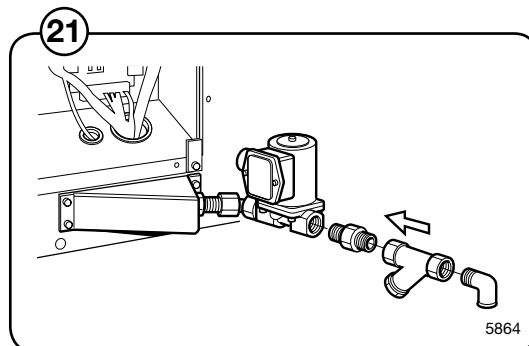
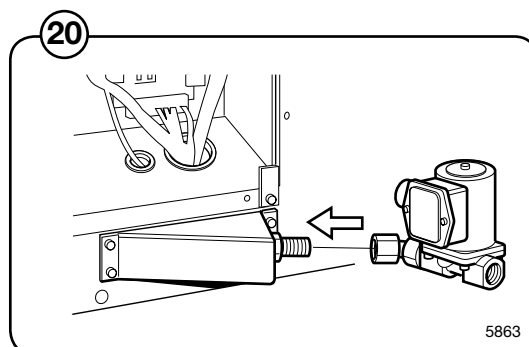
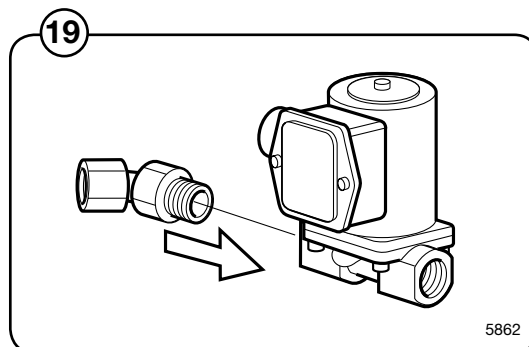
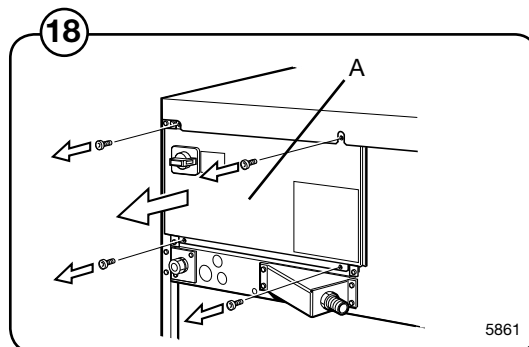



## Connection of external liquid supplies

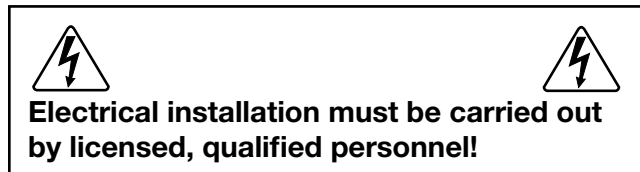

- 23 Distribution card A can be used to control machine functions, output and input signals.

24 **Outputs (110-240V AC):**

X71:1,2 Signal "Door locked, program on"

X72:1 0 V (common)

X72:2 Liquid supply 1

X72:3 Liquid supply 2

X72:4 Liquid supply 3

X72:5 Liquid supply 4

X73:1 Detergent box 1 (Y11)

X73:2 Detergent box 2 (Y12)

X73:3 Detergent box 3 (Y13)

X73:4 Detergent box 4 (Y14)

X73:5 Detergent box 2 (Y22)

**Inputs:**

X70:1,2 Paus/PC5

X70:3,4 Start/Stop

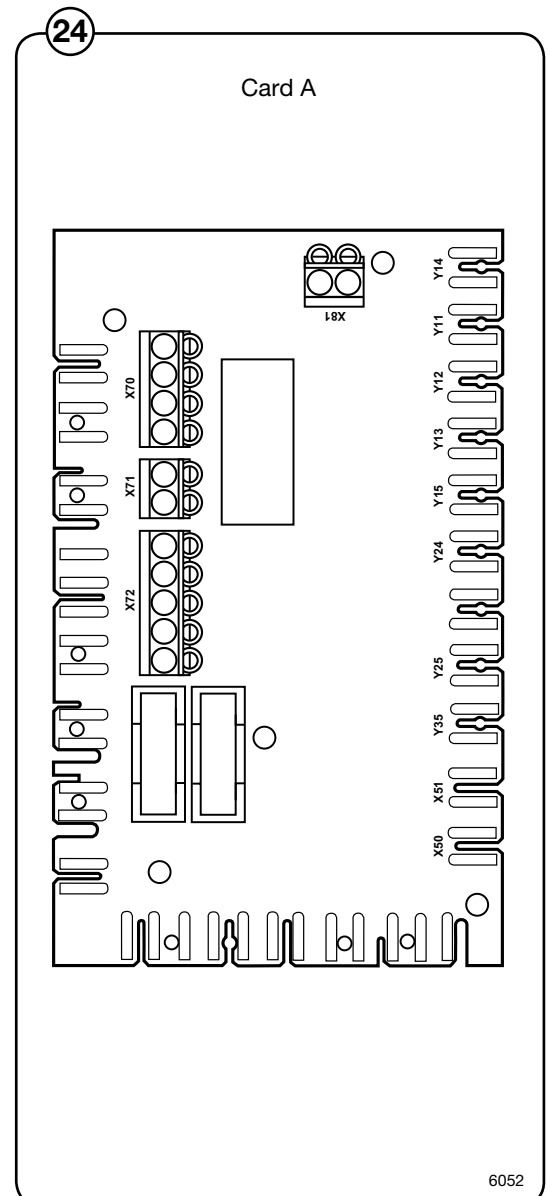
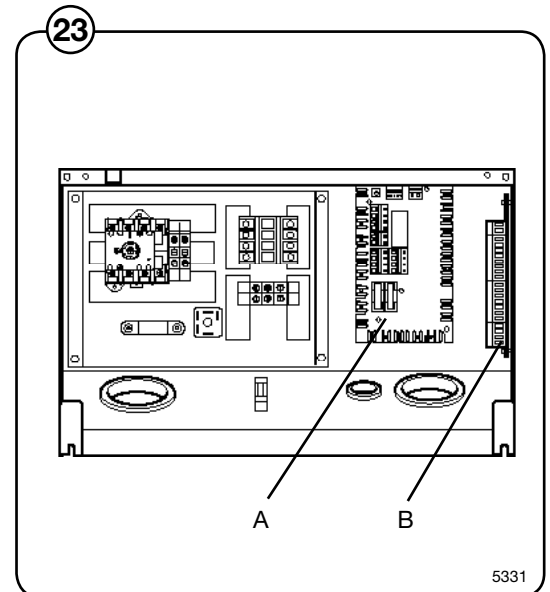

- 25 If more signals are required the machine can be equipped with a second distribution card B.

**Outputs (200-240V AC):**

X75:1	0 V (common)
X75:2	Liquid supply 5
X75:3	Liquid supply 6
X75:4	Liquid supply 7
X75:5	Liquid supply 8
X76:1	0 V (common)
X76:2	Drain lock
X76:3	Drain A
X76:4	Drain B
X76:5	Drain C
X76:6	Inlet A
X76:7	Inlet B
X76:8	Inlet C
X77:1	Buzzer (N)
X77:2	Buzzer (L1)

**Inputs:**

X74:1,2	Switch between heating 1/heating 2
X74:3,4	No function

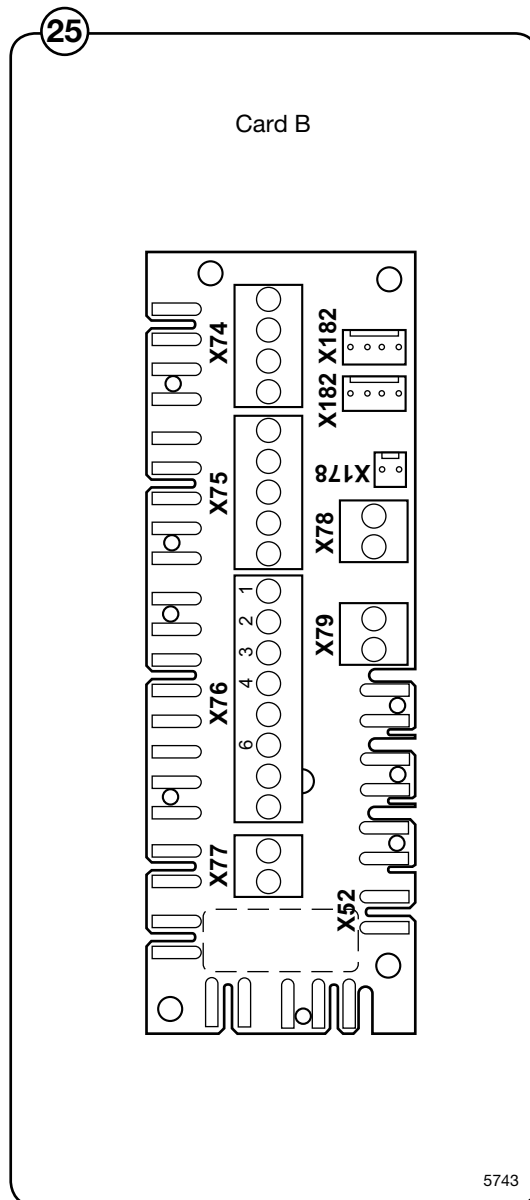

## Electrical installation



**Electrical installation must be carried out by licensed, qualified personnel!**



**Machines with frequency-controlled motors can be incompatible with certain types of earth leakage circuit breakers. It is important to know that the machines are designed to provide a high level of personal safety, which is why items such as ground-fault interrupting circuit breakers are not necessary. If you still want to connect your machine across ground fault circuit breaker, please remember the following:**

- **contact a licensed, qualified electrician to ensure that the appropriate type of breaker is chosen and that the breaker rating is correct**
- **for maximum reliability, connect only one machine per circuit breaker**
- **it is important that the earth wire is properly connected, including to the ground fault circuit breaker.**

An individual electrical disconnect must be provided in proximity to each machine.

The connecting cable should hang in a gentle curve.

For proper circuit breaker sizes, see table on the next page.

## Single-phase connection:

- 26 Connect the earth and other two wires as shown in example "1AC" in the figure.

For the W645 and W660, special circuit breaker considerations must be made. The following guidelines will assist you in selecting an appropriate circuit breaker.

**W645:**

Select a 25 Amp circuit breaker capable of maintaining at 60 Amperes for 8 seconds.

**W660:**

Select a 30 Amp circuit breaker capable of maintaining at 70 Amperes for 7 seconds.

## Three-phase connection:

- 27 Connect the earth and the three phases as shown in example "3AC" in the figure.

When the installation is completed, check:

- that the drum is empty.
- that the machine operates by turning on the mains switch, starting the machine and using RAPID ADVANCE to reach the spin cycle (see operations manual).

**IMPORTANT**

When making power supply connections to machines rated 208-240V AC, **do not** connect any phase measuring in excess of 125 V AC (with respect to earth ground) to the L1 or L2 terminals on the connection block. So-called "stinger legs" must be connected to the "L3" terminal, which does not feed power to the control circuits of the machine.

On three-phase models (except SU677), check that the drum rotates in the direction indicated on the machine while in extraction. If the direction is incorrect, reverse two of the power line phases to correct the rotation direction, while observing the note above.

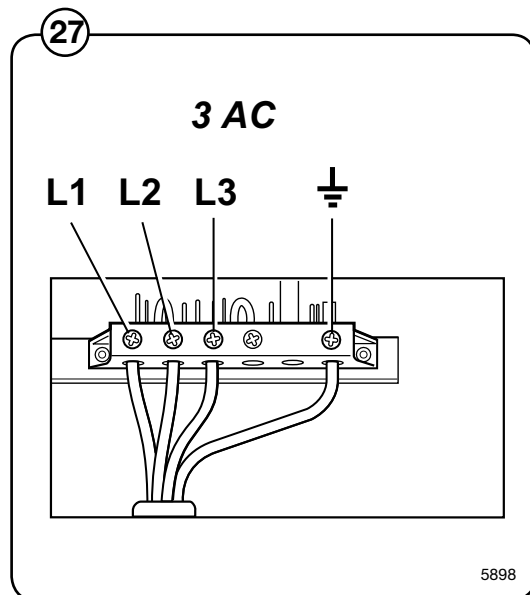
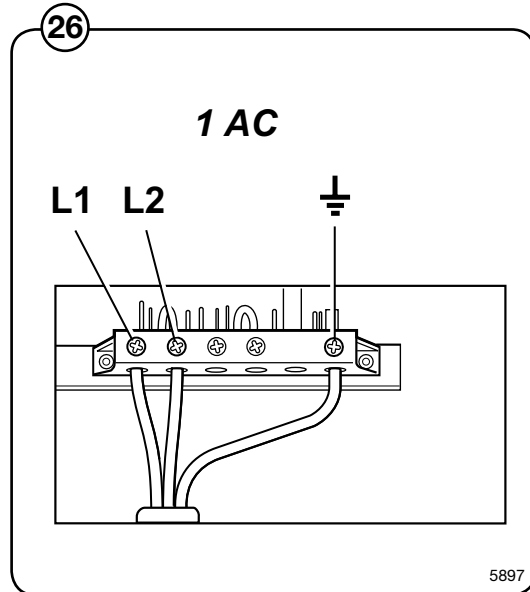

## EX618

Heating alternative	Voltage alternative	Total kW	Fuse A
No heating or Steam heating	100-120 V 1 AC	1.1	15
	208-240 V 1 AC	1.1	15
El heating	220-230 V 3 AC	7	20

## EX625

Heating alternative	Voltage alternative	Total kW	Fuse A
No heating or Steam heating	208-240 V 1 AC	1.3	15
	208-240 V 3 AC	9.2	30

## EX630

Heating alternative	Voltage alternative	Total kW	Fuse A
No heating or Steam heating	208-240 V 1 AC	1.6	15
	208-240 V 3 AC	12.5	60
El heating	208-240 V 1 AC	11.8	35
	440/480 V 3 AC	13.5	20

**EX645**

Heating alternative	Voltage alternative	Total kW	Fuse A
No heating or Steam heating	208-240 V 1 AC	2.3	15

**EX660**

Heating alternative	Voltage alternative	Total kW	Fuse A
No heating	208-240 V 1 AC	2.6	15
or Steam heating	480 V 1 AC	2.6	15
El heating	208-240 V 3 AC	18.3	60

**EX677**

Heating alternative	Voltage alternative	Total kW	Fuse A
No heating or Steam heating	208-240 V 1 AC	2.1	15

## SU620

Heating alternative	Voltage alternative	Total kW	Circuit breaker A
No heating	120 V 1 AC	0.5	15
or Steam heating	208-240 V 1 AC	0.5	15

## SU630

Heating alternative	Voltage alternative	Total kW	Circuit breaker A
No heating	120 V 1 AC	0.8	15
or Steam heating	208-240 V 1 AC	0.8	15
EI heating	208-240 V 1 AC	9.2	50
	208-240 V 3 AC	9.3	30

## SU645

Heating alternative	Voltage alternative	Total kW	Circuit breaker A
No heating	120 V 1 AC	1	15
or Steam heating	208-240 V 1 AC	1	15
EI heating	208-240 V 1 AC	12.1	60

**SU660**

Heating alternative	Voltage alternative	Total kW	Circuit breaker A
No heating	120 V 1 AC	1.4	20
or Steam heating	208-240 V 1 AC	1.4	15

**SU677**

Heating alternative	Voltage alternative	Total kW	Circuit breaker A
No heating	120 V 1 AC	1.6	20
or Steam heating	208-240 V 1 AC	1.6	15



---

## Function checks

### Manual operation

- Switch on the machine's main switch.
- Open the manual valves for water and for steam if the machine has steam heating.

In the operating manual, chapter "Manual operation", one can find how to operate the machine manually.

- Check that the drum is empty and close the door.
- Close the drain valve.
- Operate the machine manually to fill with cold water, then hot water. Check that these water supplies are connected as they should be.
- Start the motor on wash action, and check that the motor is revolving clockwise and anticlockwise alternately, as normal for wash action.
- Start heating by entering a final temperature and then pressing **START**. Check that the steam valve opens or the heating element relay reacts, as appropriate.
- Check that all sources of detergent supply are working as they should, including the built-in detergent supply compartments, where present.
- Check the water and steam connections and the drain valve for signs of any leakages.
- Empty the water from the machine and open its door.



# When reliable laundry and wetcleaning equipment is desired, the choice is Wascomat!

The world's oldest and leading manufacturer of commercial laundry equipment for coin laundries, hotels, motels, nursing homes and any other institutional laundry use, and the environmentally safe, wetcleaning "dual-use" systems for drycleaners.

## WASCOMAT PROVIDES "PEACE OF MIND GUARANTEE"

Backed by a company that's been in the laundry equipment business for over 100 years and has earned a reputation as the standard of quality worldwide, Wascomat dealers provide:

- Free survey of your laundry needs
- Laundry design and layout
- Quality laundry equipment in a size and model for every need
- Installation, start-up and training
- Worldwide parts and service
- Best warranty in the business
- "Lease-a-Laundry Program", which includes the laundry equipment installation and ongoing service

## EXPAND, MODERNIZE, RETOOL OR BUILD A NEW LAUNDRY WITH LOW-COST FINANCING OR LEASING FROM WASCOMAT\*

With Wascomat/Viking financing or leasing you can obtain and install durable, efficient, state-of-the-art Wascomat washers, dryers and non-polluting, environmentally-friendly wetcleaning equipment to meet all anti-pollution regulations.

For more information and to apply for financing or leasing, call Viking Financial Services LLC 1-800-645-2209

# Wascomat provides efficient, quality washers, dryers, flatwork ironers and non-polluting wetcleaning equipment.

## FRONT-LOAD WASHER MODELS

Solid and soft-mount, coin operated and commercial laundry washers in standard, high and ultra-high extract models. Designed for long life and efficient water and energy use. Available from 18 to 250 lb. capacities.

## SIDE-LOAD WASHER MODELS

Pullman, Side-Load, Barrier and Clean Room washer models with high 300 to 350 G-Force extraction, designed and built for long, trouble-free life and big water and energy savings. Available from 55 to 250 lb. capacities.

## GAS EFFICIENT DRYER MODELS

Coin operated and commercial energy and gas efficient, user friendly TD dryer models with optional unique Wascomat Residual Moisture Control (RMC). Available in a size and model for every laundry need.

## AUTOMATIC FLATWORK IRONERS

A unique one-operator, fully automatic, labor saving, ironer that does it all: feeds, irons, folds, stacks and counts. Also available in fully and semi-automatic models in a size and model for every laundry need.

FOR PARTS & CUSTOMER SERVICE YOU CAN DEPEND ON WASCOMAT & ITS DEALERS



## WASCOMAT NON-POLLUTING WETCLEAN EQUIPMENT

The best alternative to Perc, uses water and complies with OSHA, EPA and all other environmental, anti-pollution regulations. Wascomat state-of-the-art wetclean technology eliminates all pollution concerns and provides the best wetcleaning and washing results. Available in a size and model for every wetcleaning need.

With the push of a button, the unique Wascomat "Dual-Use" Wetcleaner converts to an ideal laundry washer for washing shirts, comforters, drapes, all other washable garments and cleaner's wash-dry-fold customer service.



**WASCOMAT PROVIDES THE BEST CUSTOMER SERVICE WITH EXPERIENCED WORLDWIDE CUSTOMER SUPPORT, WITH AN OVER 100-YEAR TRACK RECORD.**

**WASCOMAT/VIKING FINANCIAL SERVICES PROVIDES LOW COST FINANCING AND LEASING\* FOR YOUR BUSINESS GROWTH.**

**For more information call Wascomat at 516-371-4400**



**Wascomat Laundry Equipment**

*The Standard of Quality for Over 100 Years!*

\* For qualified applicants and equipment only.